

Dimensions

Proscenium Height: 19'

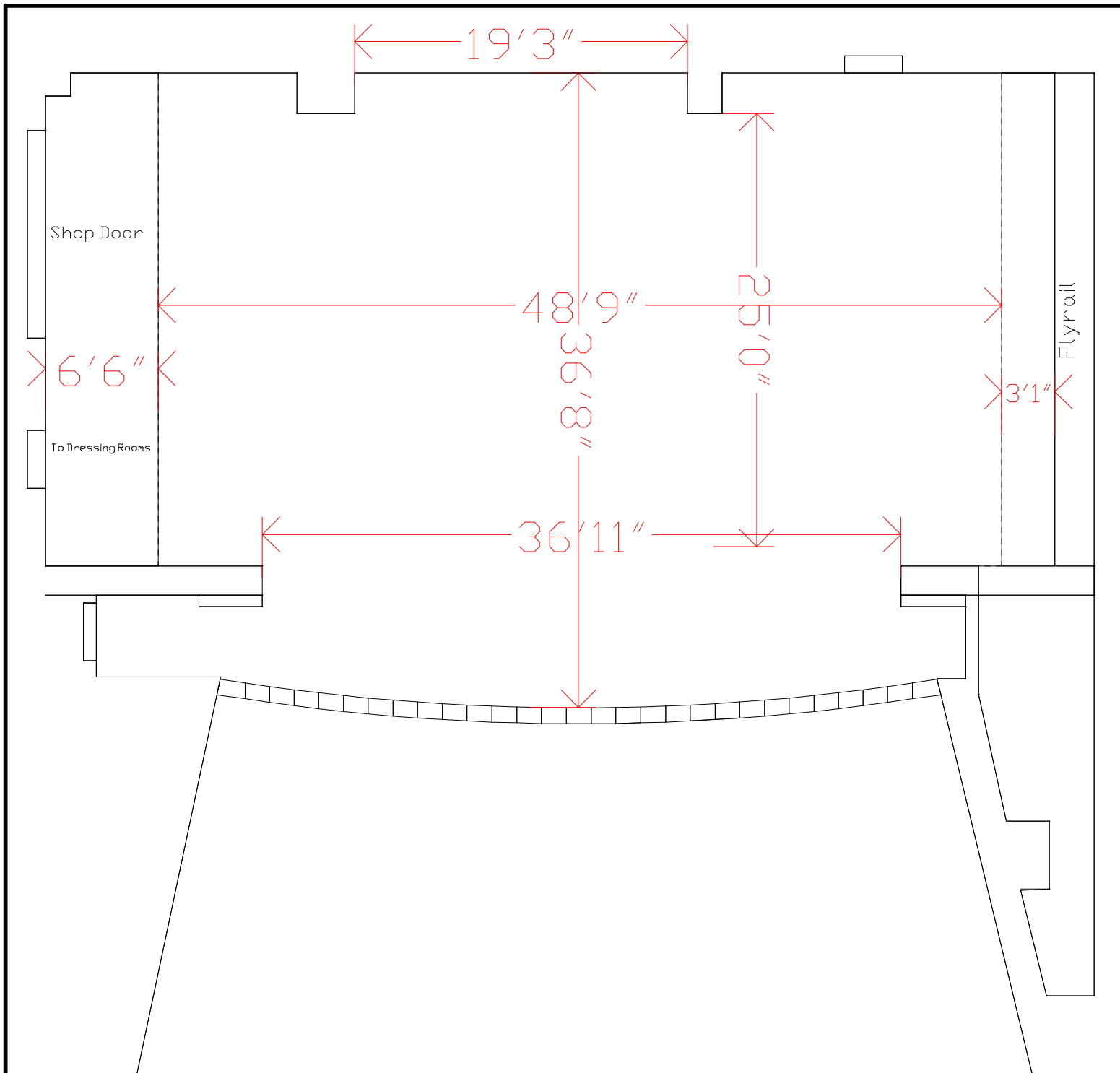

Drapery Layout

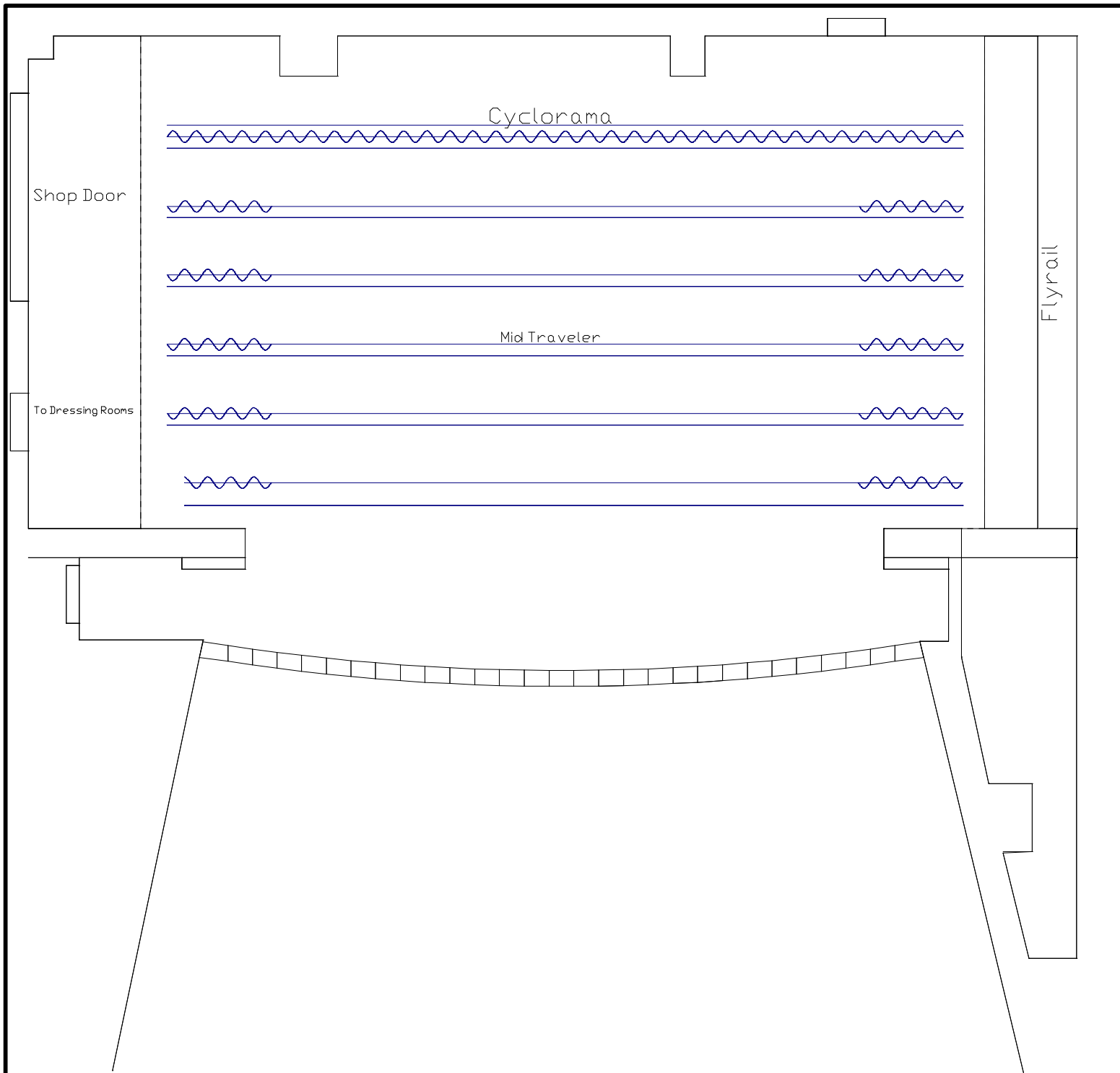

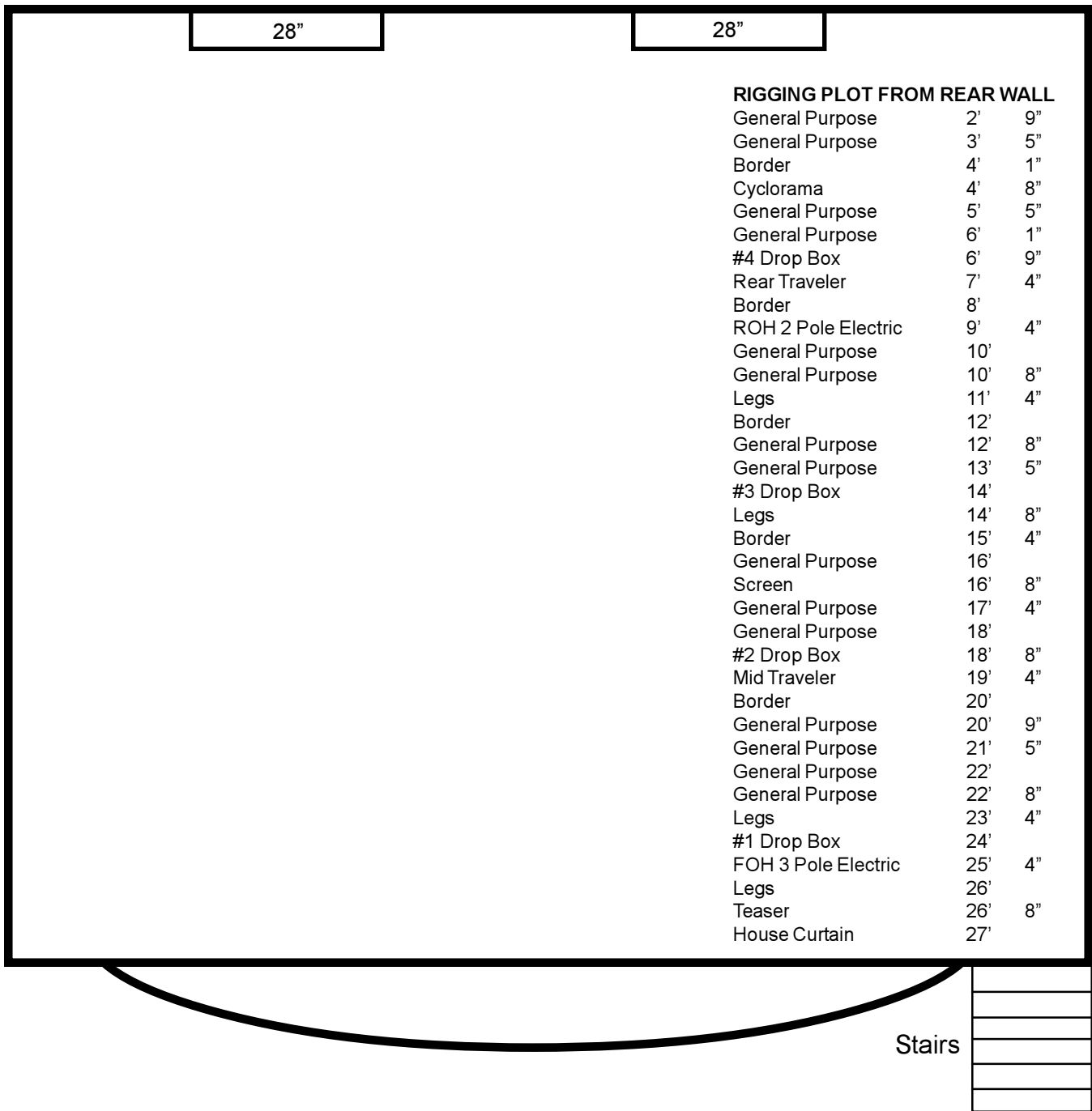

Proscenium width: 36' 10"
 Proscenium height: 24'
 Depth of stage from house curtain line: 27'
 Center line of apron to curtain line: 10'
 Stage Right Wing: 6'
 Stage Left Wing: None
 Vertical Fly Space: 40'

Orchestra Pit: 16' 5" deep x 7' 3" high under stage
 Orchestra pit stage opening: 5' x 10" @ ceiling
 Green Room: 9' 4" x 12' 6"
 Women's Dressing Room: 11' x 16' 6", 10 chairs
 Men's Dressing Room: 11' x 12' 6", 12 chairs
 Overhead doors from loading dock and workshop
 12' x 12' (off stage right wing)

Roane State Community College Theatre
Harriman, Tennessee